

Over the Garden Gate



www.txmg.org/wichita

Volume XIV, No 10, October, 2022

Please Pray For Rain!

Local Events

October 4, 5:30 pm: The Wichita County Master Gardener Association will meet at Rolling Meadows. We will be catching up on business.

October 20, 5:00 pm: The Burk Garden Club will meet at First Bank, in their community room. The program will be brought by commissioner Mickey Fincannon.



Enter your volunteer (15) & Training (6) hours in the MG
volunteer management system <https://vms.texasmg.org/>

Association Contacts: Rob Cherry, President, 940-500-2675 ; Judy Beechler, Vice-president, 940-224-6348; Georgia Spoonemore, Secretary, 580-467-4696; Mary Alfert, Treasurer, 940-782-9745.

State Directors: Dennis Dohrer and Anne Dohrer; alternates: Mary Barry and Marie Hoover.

WCMG Webpage: Michelle Howard, administrator **Newsletter & Facebook:** Gail Elmore, editor/admin

Educational programs of the Texas A&M Agrilife Extension Service are open to all people without regard to race, color, religion, sex, national origin, age, disability, genetic information or veteran status. The Texas A&M University System, U.S. Department of Agriculture, and the County Commissioners Courts of Texas Cooperating.

Michelle's Project!

I was so excited to see Twice-Stubbed Lady Beetles on my crape myrtle.

I have had Crape Myrtle Bark Scale on both my crape myrtles for a few years now. One of the recommended chemical controls is a systemic drench application of Imidacloprid in March, which can take two months to have an impact on the scale. This would coincide with blooming, which would harm the many bees that collect pollen at this time. So instead, I have chosen to gently wash the scale off the trees with a wet cloth after the leaves have fallen off in fall and again in late winter. This has helped control their numbers.

The last two summers I have noticed a few of the Twice-Stubbed Lady Beetles on my trees, but with so many more beetles this year, they have definitely put a huge dent in the number of scale still on the trees. And rather than just seeing adult beetles, they are also in both the larval and pupal stages. I will leave all plant debris in the area this fall for any adult beetles who may overwinter in it, hoping to see a repeat of this again next year.



I found my information at these websites:

https://aggie-horticulture.tamu.edu/galveston/beneficials/beneficial-16_twicestabbed_ladybug.htm

<https://extensionentomology.tamu.edu/insects/crapemyrtle-bark-scale/>

If you have this scale, you may find these websites useful.

Thanks,
Michelle

Top, right: Ladybug larva and **Bottom:** Ladybug pupa in various stages.

Photos & article from Michelle Howard.



Farmer's Market



Pictures from the September Market. On Sept 10 a group of gardeners from Wichita County met at the "new " Market at 8th and Austin. We gave away over 100 herb plants and lots of seed packs.

We enjoyed being "inside " again and visiting with over 150 people.

Thanks to everyone who provided plants and seeds and a special thanks to all who came.

Photos & comments from Marilyn Putthoff.



Here are pictures taken at the Amarillo Botanical Gardens in August. The scenes with what looks like Palo Duro Canyon in the background are native plants with a mural behind them. Worth stopping to see if you're in Amarillo. Photos & comments

from
Mary
Rhoads.

Traveling Gardener

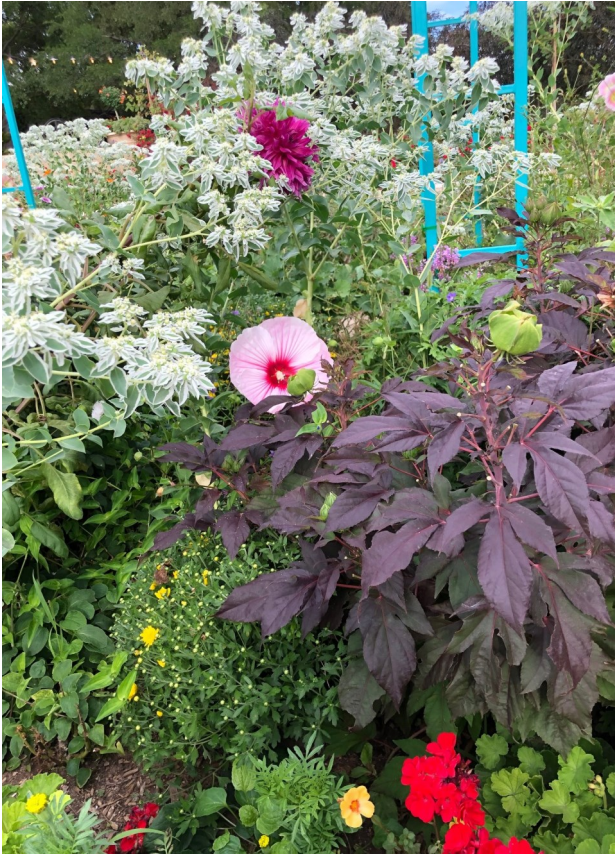

Mary's Yard

Passion flower (top, left), spider lily (top, right), salvia (bottom, left) , and chives (bottom, right) blooming in my garden now. Photos & comments from Mary Rhoads.





Top: First peach of this year's crop off a peach tree that is a descendent of a tree brought to Texas when my grandfather's family immigrated to Texas in the 1870's. These trees come back true from seed and are very tough and long-lived. The peaches are white cling and they ripen this time of year on into October.

Bottom, left: Garden critter. Grasshopper.

Right: Goldenrod (solidago). Photos & comments from Mary Rhoads.



Traveling Gardener at Home

Photos & comments from Becky Trammell

Top: Rosemary

Center: Desert Willow



Bottom: Russian Sage





Left: Hibiscus & Bee

Right: Frogfruit

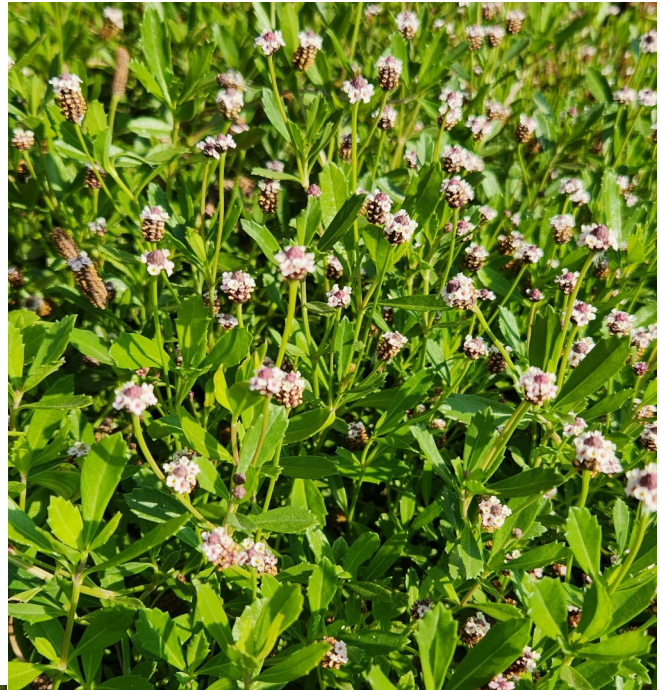

Left: Drift Rose

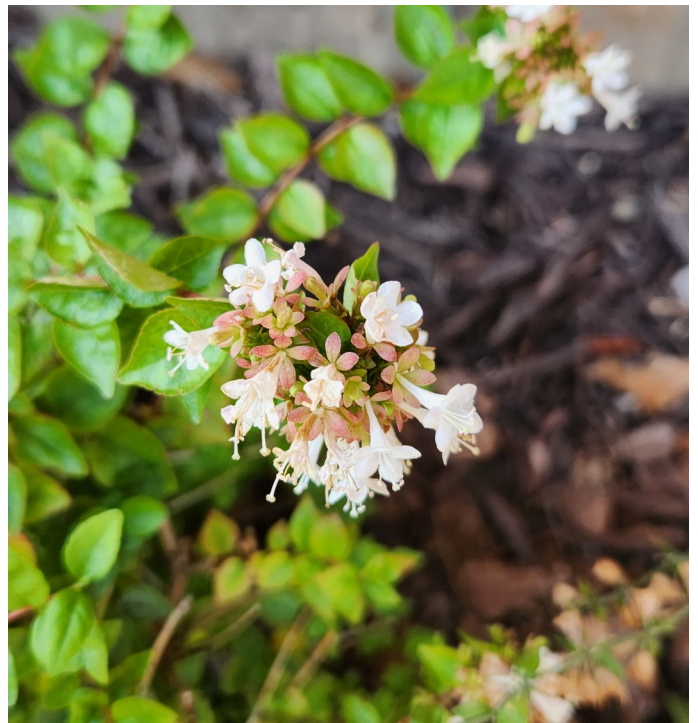

Right: Abelia

Kids at Work

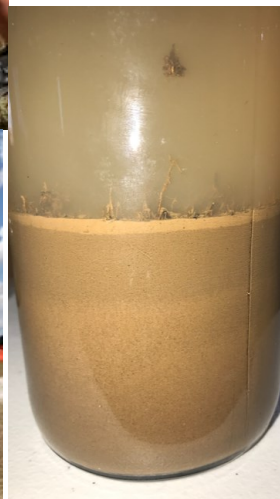

I'm so Excited to announce our raised beds at the Hope Christian Academy have been built and filled. This week we did soil analysis. (Left) Test shows the ratio of sand/silt/clay. Such an exciting time for these kids!

Photos & comments from Georgia Spoonemore.





Our Hope Christian Kindergarten is busy learning about and raising Monarch Butterflies. From egg to wings has been a wonderful success. Photos & comments from Georgia Spoonemore.





Elsie's Beauties!

My luscious St Augustine yard
and some butterflies!

Photos & comments from Elsie
Berry.

